



Title of Document:	<b>HANDLING MANUAL</b>	Issue No. CHM-1-2777	Rev. 1
Customer:		Issue date: June 30, 2023	
Title subject:	AYU2T Connector	Revision date: August 23, 2023	

This handling manual describes the points to observe in handling the AYU2T connector.  
Read it through before the handling and keep it at the place where those who handle it can see anytime.

## C O N T E N T S

	Page
1. Product Name and Model Number.....	2
2. Storage .....	2
2-1 Storing the connectors .....	2
2-2 Storing the mounted products .....	2
3. Each Part Name .....	2
4. Recommended PC Board Layout (Receptacle) .....	3
5. Soldering Precautions (Receptacle).....	3
6. Mating the Connector .....	4
6-1 How to insert the plug harness.....	4
6-2 How to extract the plug harness .....	7
7. Handling Precautions .....	9

Prepared by: <i>N.Tanaka</i>	Checked by: <i>M.Matsunaka</i>	Reviewed by: <i>S.Koga</i>	Approved by: <i>A.Tochi</i>
---------------------------------	-----------------------------------	-------------------------------	--------------------------------

<b>JST</b>	Title subject: AYU2T Connector	No. CHM-1-2777
------------	--------------------------------	----------------

## 1. Product Name and Model Number

Product name		Model number
Plug harness	Both-ended products	AYU2T-1HBR-D( )N(HF) <sup>(Note1)</sup>
Receptacle	Embossed-taping products	AYU2T-1B-GA-GA-ETY(HF)
	Main body	AYU2T-1B-GA-GA(HF)

Note<sub>1</sub>: Figures in ( ) denote cable length.

e.g. 100 mm-long both-ended plug harness: AYU2T-1HBR-D100N(HF)

Note<sub>2</sub>: (HF) denotes halogen-free products.

## 2. Storage

### 2-1 Storing the connectors

Recommended storage condition: Temperature: 5 – 35 °C, Relative humidity 60 % or less  
(Under packaging like the state of JST shipment)

Keep off direct sunlight, places exposing to such corrosive gas as industrial gas (generate from a stove and whatnot) and ammonia gas (generate from a toilet and whatnot) and dusty place.  
Also, keep the storage room from condensation.

Note that the resin molding part may break due to transportation and handling, such as processing and mating, under dry or low temperature condition.  
After unpacking, return the products in the original package to store.

Recommended storage period: 6 months after delivering to you

### 2-2 Storing the mounted products

Not leaving the crimped contact to stand in a place exposed to high humidity and direct sunshine, and not placing them directly on the ground. Keep them in a clean storage room.

## 3. Each Part Name

### Plug harness

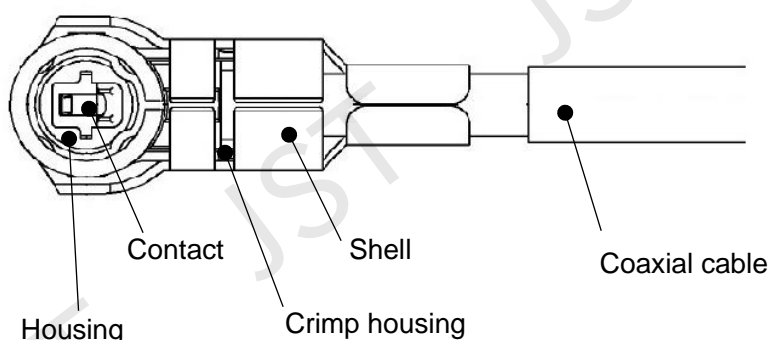

### Receptacle

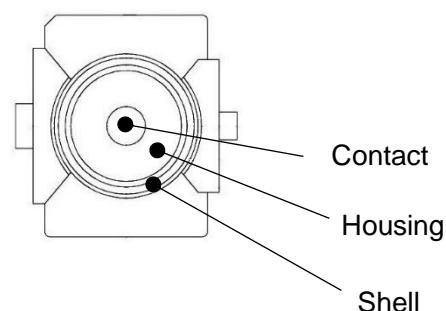

#### 4. Recommended PC board Layout (Receptacle)

PC board material: Glass-base epoxy resin

PC board thickness: 1.0 mm

PC board layout: See the below.

PC board pattern for GND pin (shell)

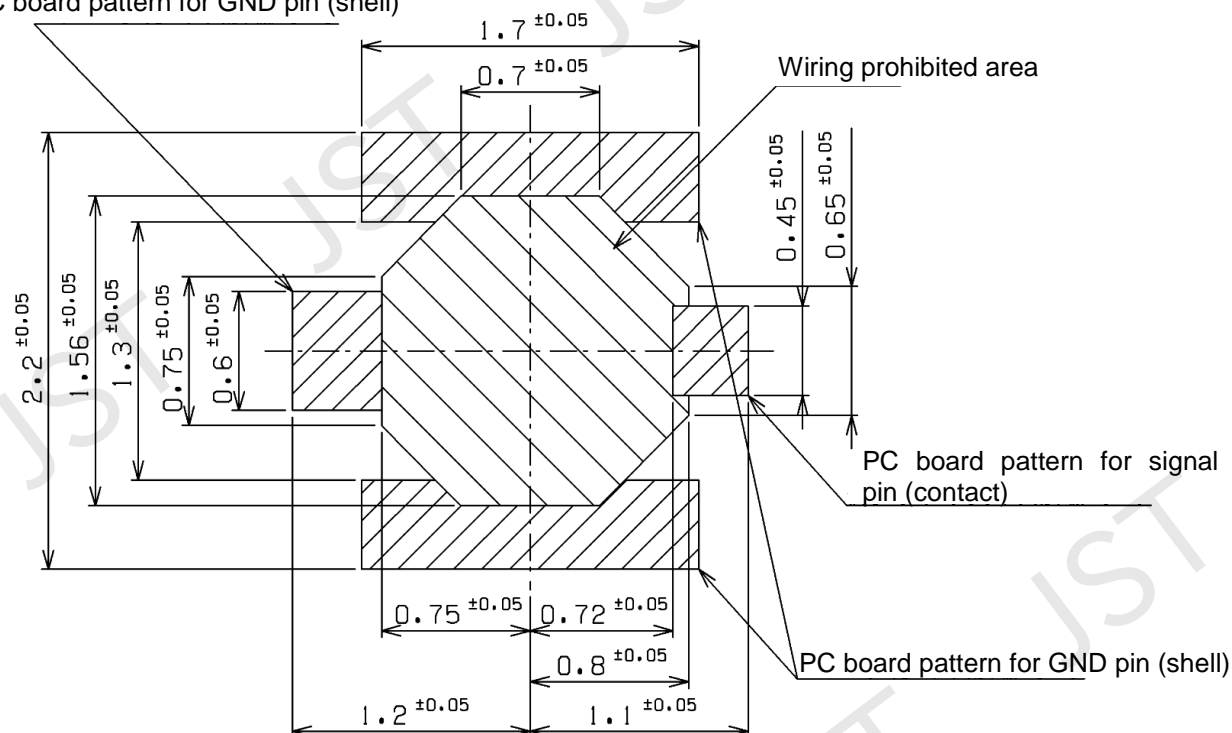

#### 5. Soldering Precautions (Receptacle)

We recommend soldering at a temperature below the temperature profile shown below.

As reflow temperature varies, depending on solder pastes to be used, PC boards, and the like, check soldering.

We recommend using a 100  $\mu$ m-thick metal mask for soldering with 80% of the opening ratio.

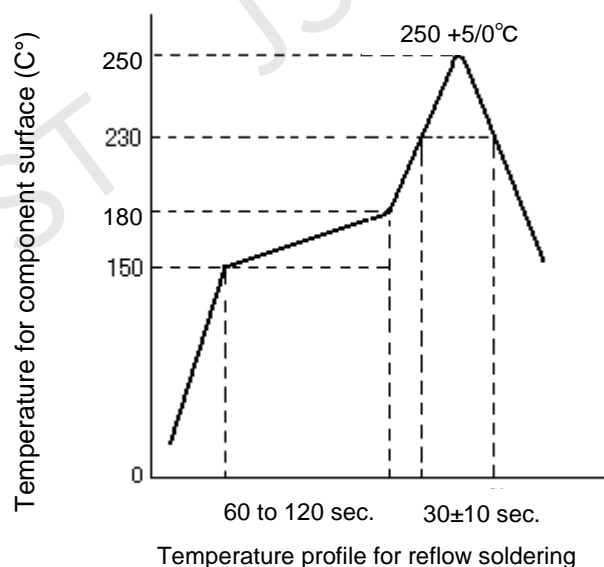

## 6. Mating the Connector

## 6-1 How to insert the plug harness

Use the insertion jig, "IT-AYU2T" for inserting the plug harness.

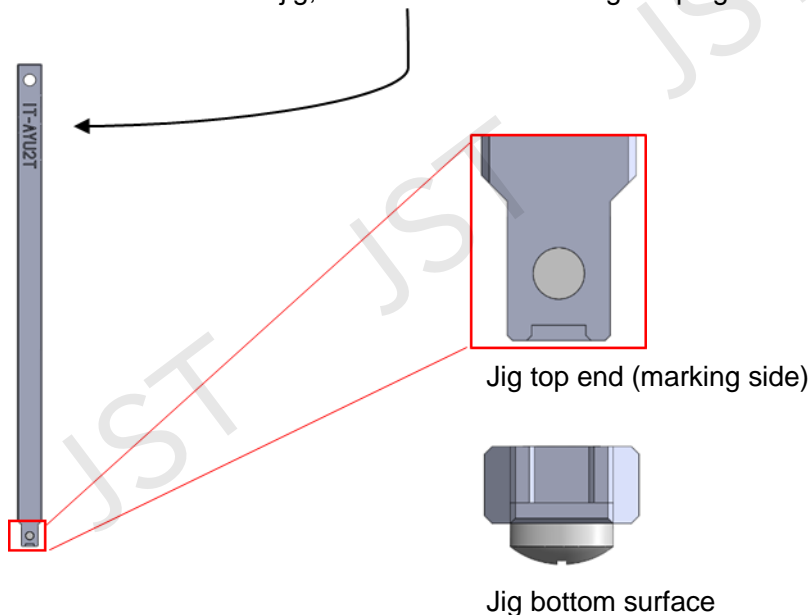

- ① Meet the mating axis of the plug harness with that of the receptacle to make an alignment.  
Do not apply an excessive load in aligning the position.  
Misalignment of the mating axis may cause connector breakage.

View from the connector side surface

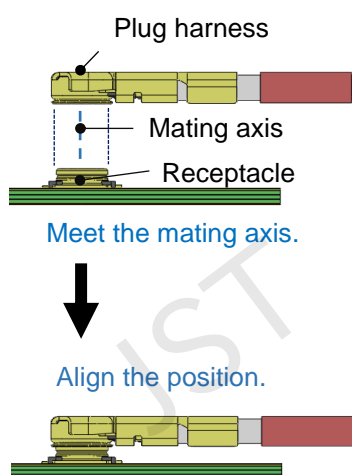

View from cable side direction

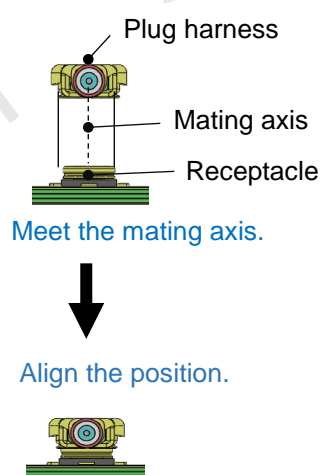

- ② Hold the plug harness and the receptacle not to deviate from the meeting position, and set the insertion jig touching it to the plug top surface from above.  
Set the jig to have a wire come to the marking side as shown below.

View from the connector side surface

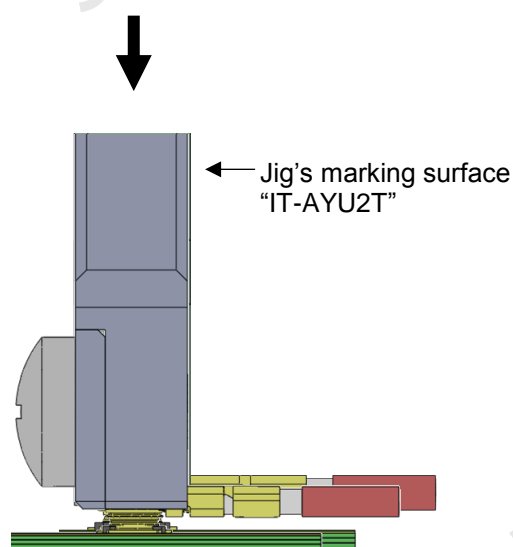
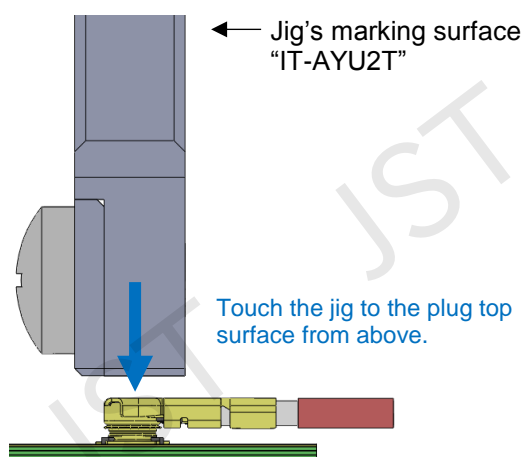

After setting the insertion jig

View from jig's marking surface side

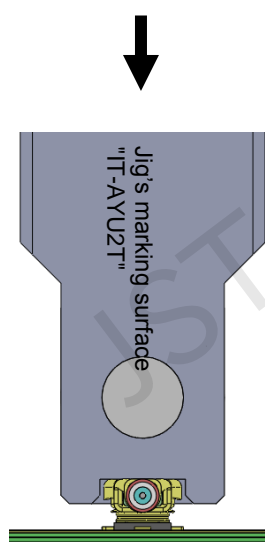
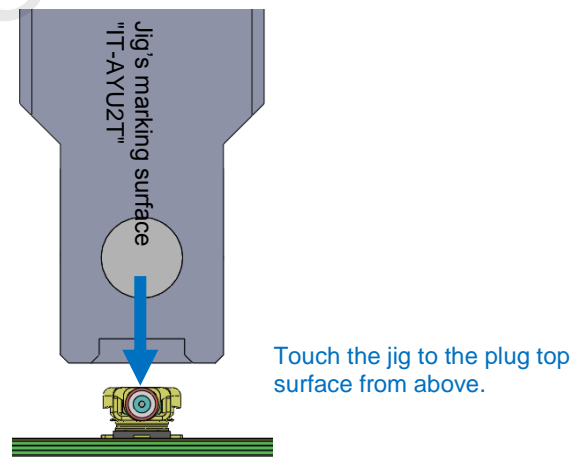

After setting the insertion jig

Jig's bottom surface side after setting the insertion jig

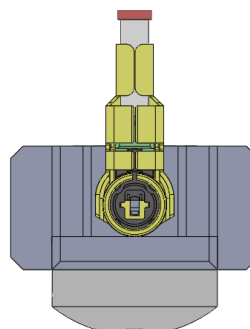

- ③ Push the set insertion jig straight until clicking.  
Do not apply a load in a diagonal direction in inserting because the connector may have breakage.

View from the connector side surface

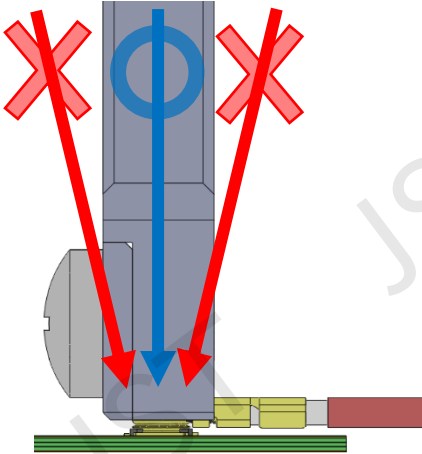

View from jig's marking surface side

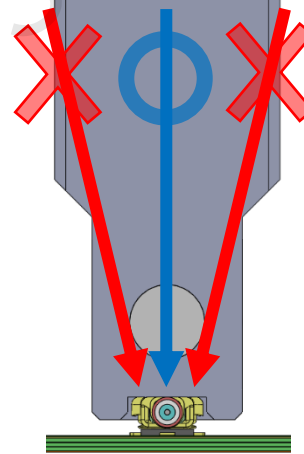

- ④ After the insertion, pull up the insertion jig to remove it from the connector.

View from the connector side surface

Pull up the jig straight.

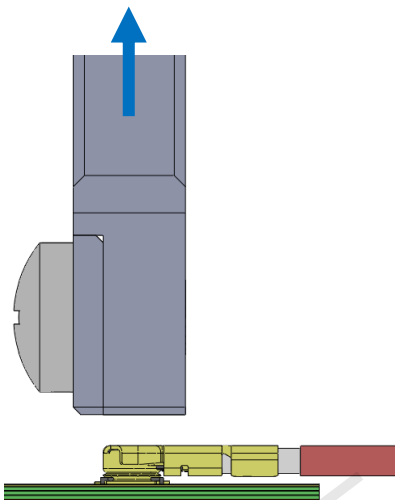

View from jig's marking surface side

Pull up the jig straight.

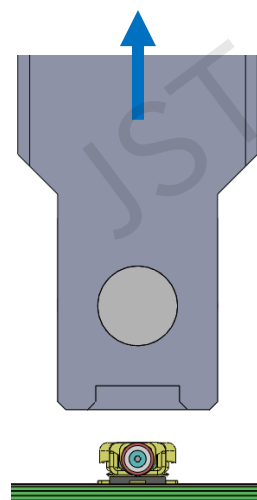

## 6-2 How to extract the plug harness

Use the extraction jig, "EJ-AYU2T" for extracting the plug harness.

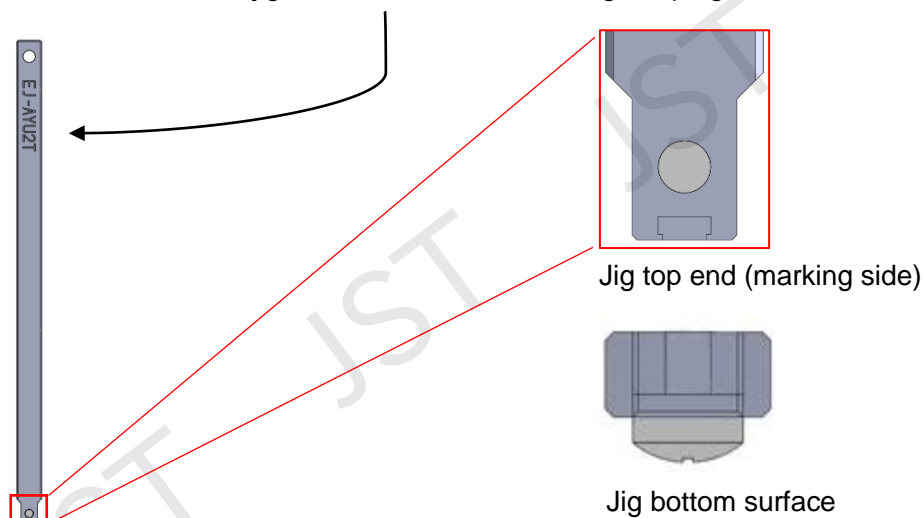

- ① Insert the extraction jig in the mating connector parallel to the plug shell from the plug harness's top end direction.

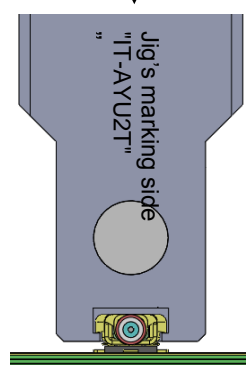
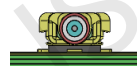
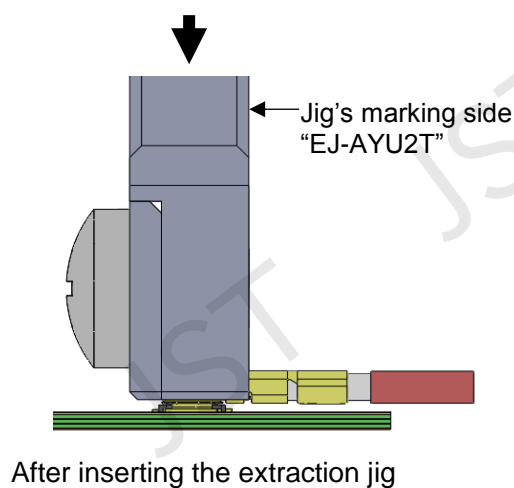
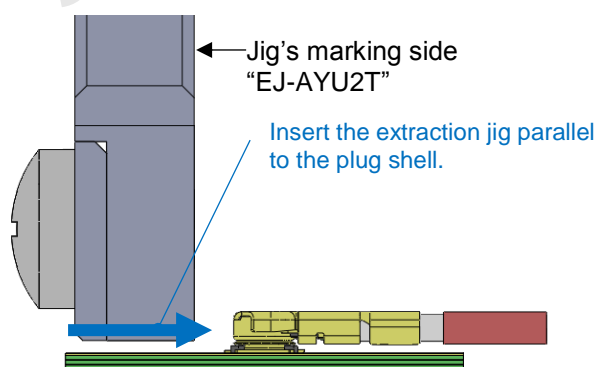

After inserting the extraction jig

Jig's bottom surface side  
after setting the insertion jig

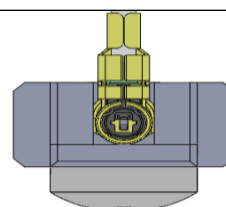

- ② Pull up the extraction jig straight to remove the plug harness from the receptacle. Do not extract the jig in a diagonal direction in extracting. Also, do not hold a wire to conduct the extraction of the plug harness without using the jig because the connector may have breakage.

View from the connector side surface

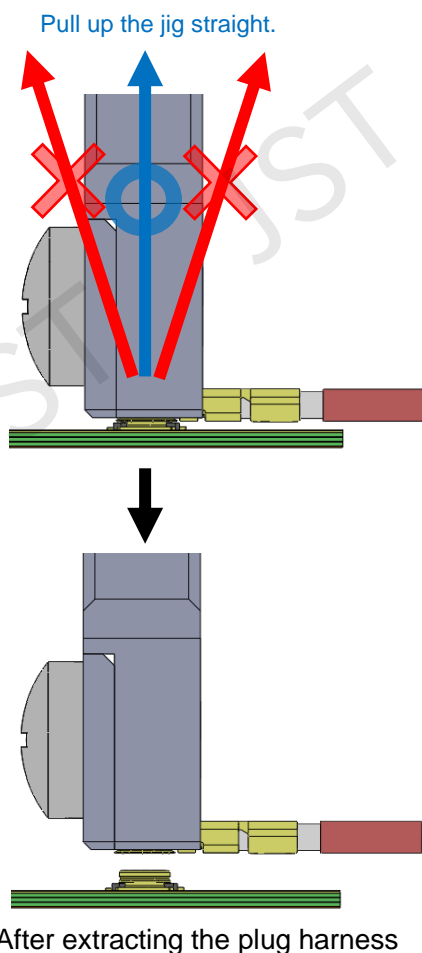

View from jig's marking surface side

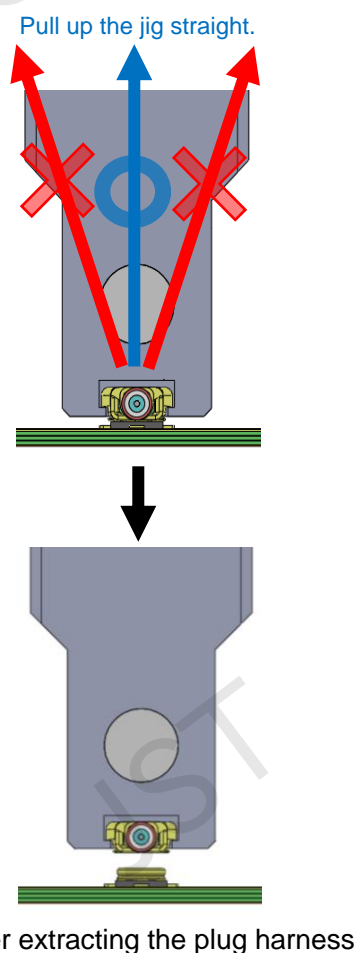

- ③ After extracting the plug harness from the receptacle, remove the jig from the plug harness.

View from the connector side surface

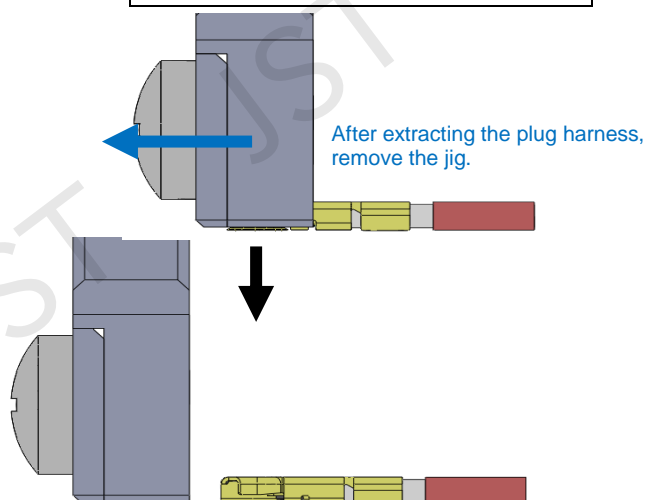



## 7. Handling Precautions

- ① Do not apply a load over the value shown below. Disconnection and deformation of the connector and disconnection and breakage of wires may be caused.

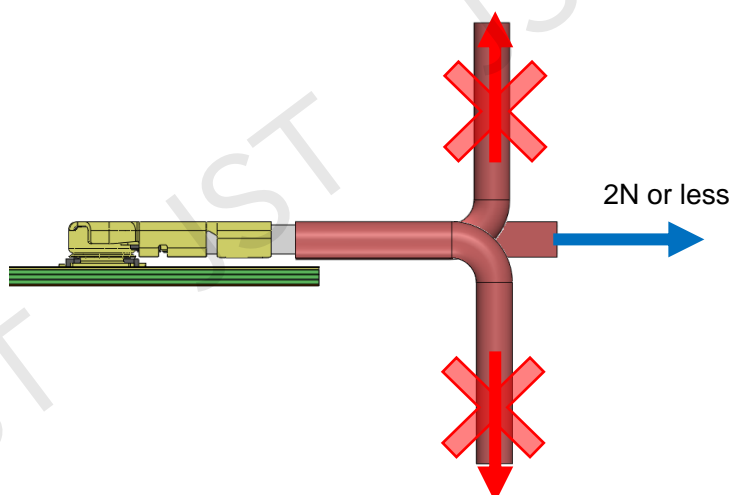

- ② Do not rotate the mating plug harness around the receptacle. Cuts and deformation of the connector may be caused.

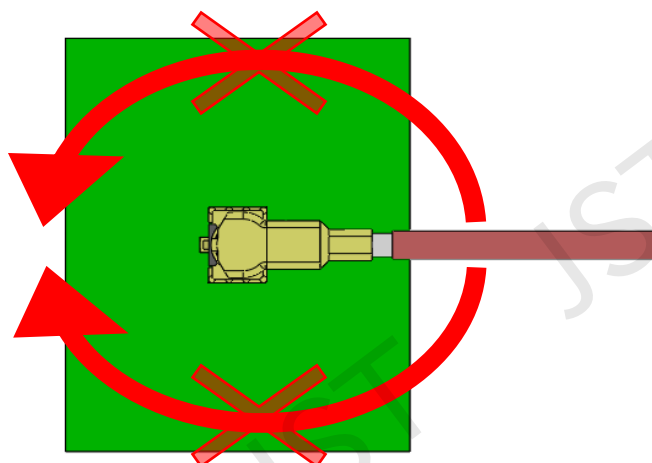

- ③ Please see that tension stemmed from wire bending is no applied to the connector in handling wires.
- ④ Don't insert foreign substances in the contact area or touch the contact area with bare hands. Also, do not disassemble the connector because connector deformation and electrical discontinuity may be caused.
- ⑤ Do not contaminate the contact with household goods such as detergent, seasoning, fruit juice and insecticide.
- ⑥ Never spray fumy insecticide in the place where the connectors are stored, because electrical discontinuity or poor soldering may be caused If adhered to them.
- ⑦ Do not apply an external load to the soldering part because the connector is deformed by applying an external load to the connector's soldering section, which may cause poor soldering, etc.
- ⑧ Do not reuse the broken connector due to mating errors and the like.  
Keep an eye on handling not to deform other parts as well through applying an external load.